

- GENERAL NOTES:**
- CONTRACTOR TO VERIFY LOCATION OF ALL BURIED SERVICES PRIOR TO START OF CONSTRUCTION.
 - TOPOGRAPHIC INFORMATION PROVIDED BY WSP CANADA INC.
 - ALL DISTURBED AREAS TO BE REINSTATED USING 100mm OF TOP SOIL AND SEED (UNLESS OTHERWISE NOTED).
 - UTILITIES TO BE SUPPORTED AT PIT LOCATION AS REQUIRED.
 - NO ROAD CUTS ON RUSSELL ROAD ARE PERMITTED UNLESS APPROVED BY UNITED COUNTRIES OF PRESCOTT & RUSSELL c/w ROAD CUT PERMIT.

- LEGEND:**
- EXISTING FENCE
 - EXISTING WATERMAIN
 - NEW WATERMAIN
 - EXISTING BELL LINE
 - EXISTING GAS LINE
 - EXISTING CABLE LINE
 - EXISTING TOP OF SLOPE
 - EXISTING BOTTOM OF SLOPE
 - EXISTING DITCH
 - EXISTING RIGHT OF WAY
 - EXISTING TREE LINE
 - EXISTING HYDRANT
 - NEW HYDRANT
 - EXISTING VALVE
 - NEW VALVE
 - NEW WATERMAIN TEE
 - NEW WATERMAIN CAP
 - EXISTING WATERMAIN TEE
 - EXISTING WATERMAIN CAP
 - NEW WATERMAIN REDUCER
 - EXISTING UTILITY POLE
 - EXISTING GUY WIRE
 - EXISTING LIGHT STANDARD
 - EXISTING BELL PEDISTAL
 - EXISTING CABLE PEDISTAL
 - EXISTING SIGN
 - TEMPORARY BENCHMARK
 - EXISTING ASPHALT
 - NEW ASPHALT
 - EXISTING CULVERT
 - NEW WATER SERVICE

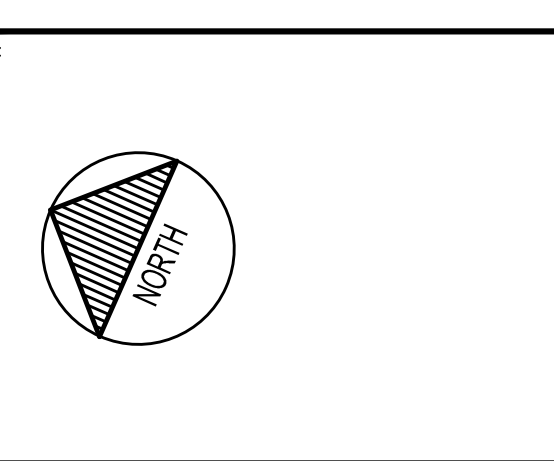

CONSULTANT:
SEAL:



WATERMAIN LOOPING

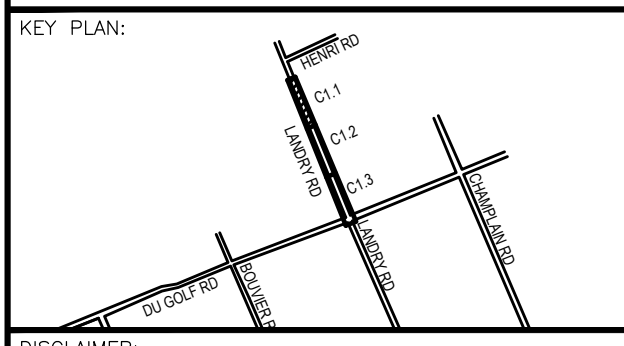

DISCLAIMER: THIS DRAWING AND DESIGN IS COPYRIGHT PROTECTED WHICH SHALL NOT BE USED, REPRODUCED OR REVISED WITHOUT WRITTEN PERMISSION BY WSP. THE CONTRACTOR SHALL CHECK AND VERIFY ALL DIMENSIONS AND UTILITY LOCATIONS AND REPORT ALL ERRORS AND OMISSIONS PRIOR TO COMMENCING WORK. THIS DRAWING IS NOT TO BE SCALED.

ISSUED FOR - REVISION:

NO.	DATE	DESCRIPTION
1	03/23/2018	ISSUED FOR TENDER

IS	RE	DATE	DESCRIPTION
121-20565-00		03/23/2018	DATE:
H1:1000			ORIGINAL SCALE:
V1:50			DESIGNED BY:
MMIC			DESIGNED BY:
DY			DRAWN BY:
MF			CHECKED BY:

DISCIPLINE: CIVIL

PLAN AND PROFILE LANDRY ROAD STA. 8+975 TO STA. 9+575

SHEET NUMBER: C1.9

SHEET #: 9 OF 12

ISSUE: ISSUED FOR TENDER

DATE: 03/23/2018

REV # 0

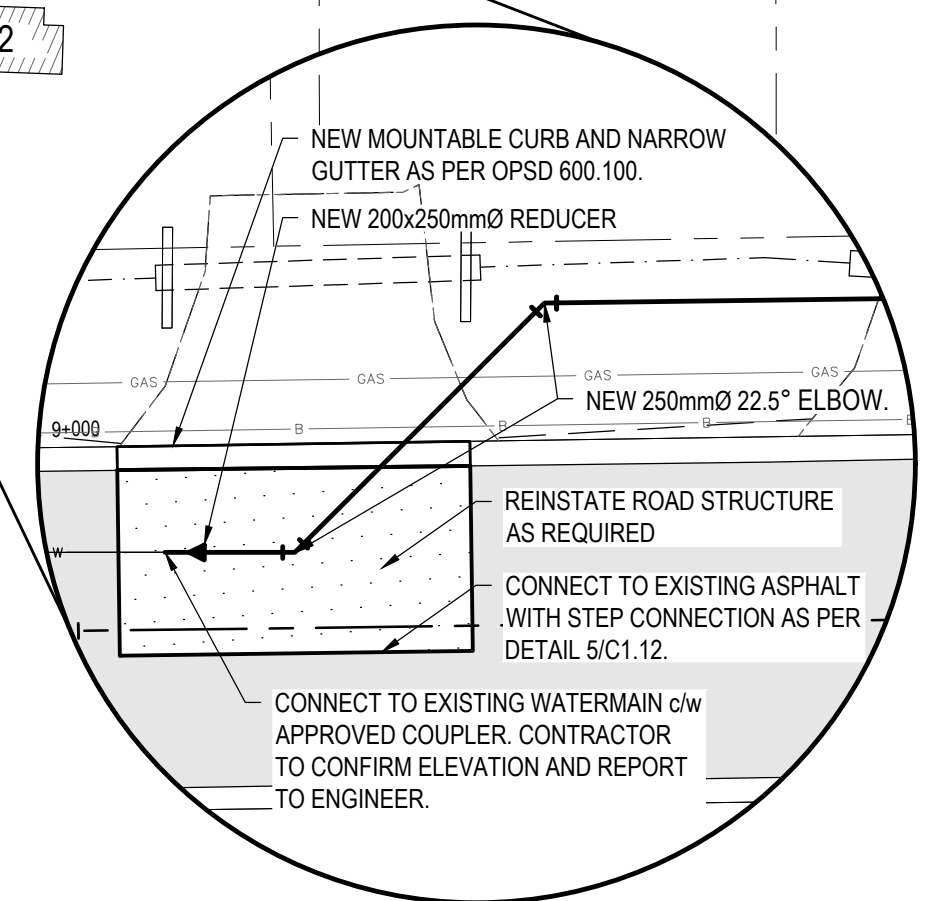
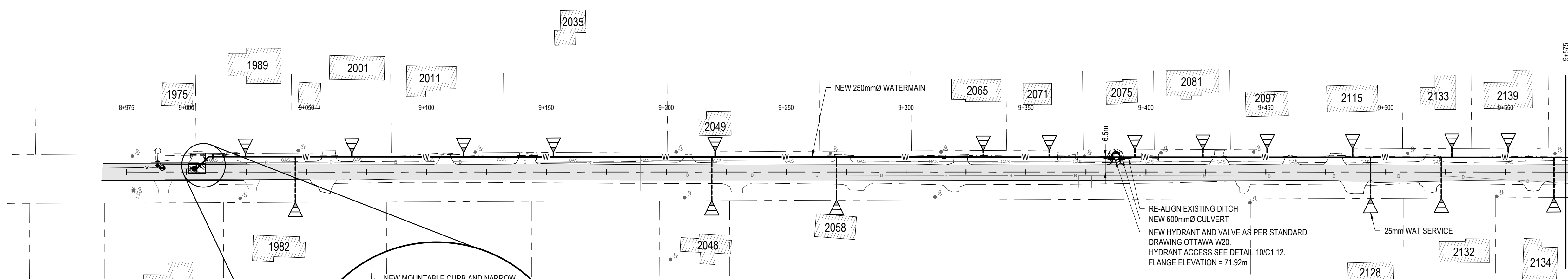

1 WATERMAIN CONNECTION DETAIL
SCALE: 1:150

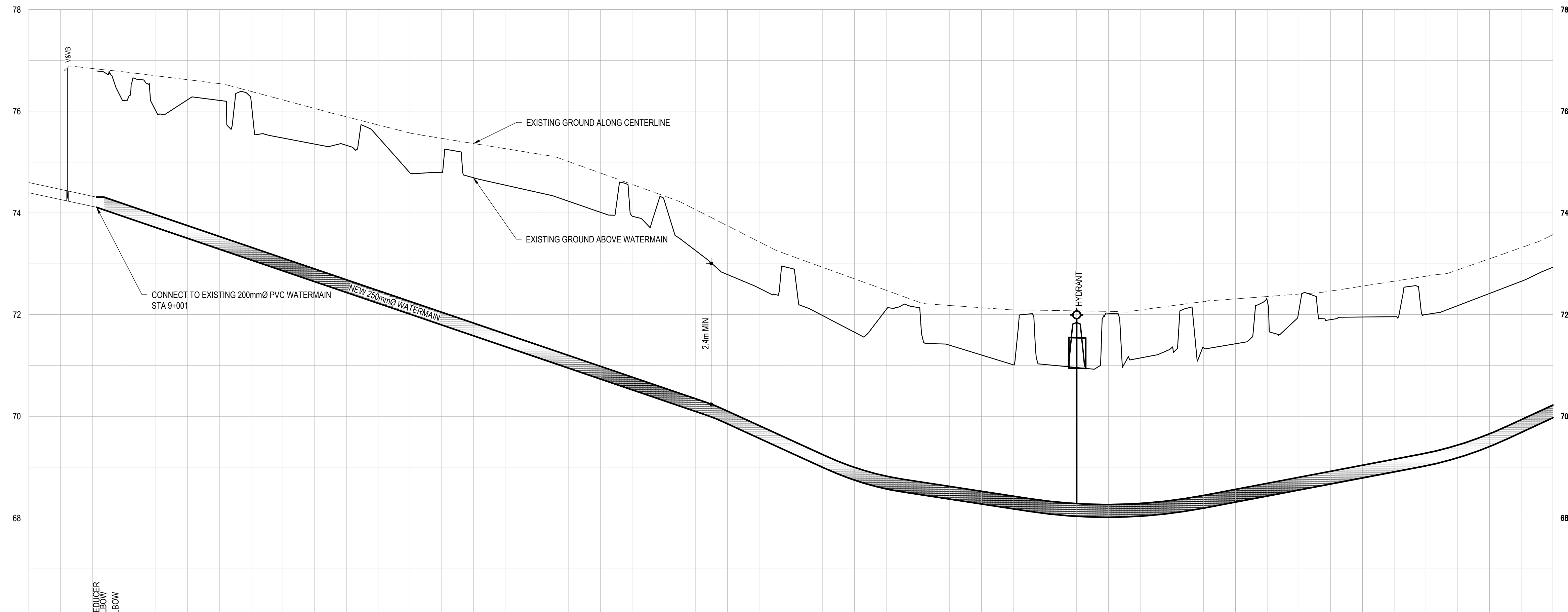

STATION	8+975	9+000	9+025	9+050	9+075	9+100	9+125	9+150	9+175	9+200	9+225	9+250	9+275	9+300	9+325	9+350	9+375	9+400	9+425	9+450	9+475	9+500	9+525	9+550	9+575	STATION	
ROAD CENTERLINE AND EG OVER WM	76.84	76.70	76.54	76.22	75.33	74.79	74.69	74.41	74.01	74.27	74.14	72.79	72.91	71.65	72.14	71.02	72.06	72.03	71.43	72.08	71.95	72.00	72.42	73.10	72.93	73.57	ROAD CENTERLINE AND EG OVER WM
TOP OF WATERMAIN	74.31	74.23	73.96	73.54	73.11	72.69	72.26	71.83	71.41	70.98	70.56	70.10	69.63	68.99	68.72	68.63	68.34	68.28	68.26	68.35	68.80	69.04	69.28	69.65	70.22	70.22	TOP OF WATERMAIN