

**WATERMAIN CONNECTION DETAIL**  
SCALE: 1:250

- GENERAL NOTES:**
- CONTRACTOR TO VERIFY LOCATION OF ALL BURIED SERVICES PRIOR TO START OF CONSTRUCTION.
  - TOPOGRAPHIC INFORMATION PROVIDED BY WSP CANADA INC.
  - ALL DISTURBED AREAS TO BE REINSTATED USING 100mm OF TOP SOIL AND SEED (UNLESS OTHERWISE NOTED).
  - UTILITIES TO BE SUPPORTED AT PIT LOCATION AS REQUIRED.
  - NO ROAD CUTS ON RUSSELL ROAD ARE PERMITTED UNLESS APPROVED BY UNITED COUNTIES OF PRESCOTT & RUSSELL c/w ROAD CUT PERMIT.
- LEGEND:**
- EXISTING FENCE
  - EXISTING WATERMAIN
  - NEW WATERMAIN
  - EXISTING BELL LINE
  - EXISTING GAS LINE
  - EXISTING CABLE LINE
  - EXISTING TOP OF SLOPE
  - EXISTING BOTTOM OF SLOPE
  - EXISTING DITCH
  - EXISTING RIGHT OF WAY
  - EXISTING TREE LINE
  - EXISTING HYDRANT
  - NEW HYDRANT
  - EXISTING VALVE
  - NEW VALVE
  - NEW WATERMAIN TEE
  - NEW WATERMAIN CAP
  - EXISTING WATERMAIN TEE
  - EXISTING WATERMAIN CAP
  - NEW WATERMAIN REDUCER
  - EXISTING UTILITY POLE
  - EXISTING GUY WIRE
  - EXISTING LIGHT STANDARD
  - EXISTING BELL PEDISTAL
  - EXISTING CABLE PEDISTAL
  - EXISTING SIGN
  - TEMPORARY BENCHMARK
  - EXISTING ASPHALT
  - NEW ASPHALT
  - EXISTING CULVERT
  - NEW WATER SERVICE

**WSP**  
1224 GARDINERS ROAD, SUITE 201  
KINGSTON, ONTARIO  
CANADA K7P 0G2  
PHONE: 613-634-7373  
WWW.WSP.COM

CONSULTANT:

SEAL:

CLIENT:

CLIENT REF. #:

PROJECT:

**WATERMAIN LOOPING**

KEY PLAN:

DISCLAIMER: THIS DRAWING AND DESIGN IS COPYRIGHT PROTECTED WHICH SHALL NOT BE USED, REPRODUCED OR REVISED WITHOUT WRITTEN PERMISSION BY WSP. THE CONTRACTOR SHALL CHECK AND VERIFY ALL DIMENSIONS AND UTILITY LOCATIONS AND REPORT ALL ERRORS AND OMISSIONS PRIOR TO COMMENCING WORK. THIS DRAWING IS NOT TO BE SCALED.

ISSUED FOR - REVISION:

IS	RE	DATE	DESCRIPTION
1		03/23/2018	ISSUED FOR TENDER

PROJECT NO: 121-20565-00 DATE: 03/23/2018

ORIGINAL SCALE: H1:1000 V1:50 IF THIS BAR IS NOT 25mm LONG, ADJUST YOUR PLOTTING SCALE.

DESIGNED BY: MMIC

DRAWN BY: DY

CHECKED BY: MF

DISCIPLINE: CIVIL

TITLE: PLAN AND PROFILE LANDRY ROAD STA. 10+175 TO STA. 10+775

SHEET NUMBER: C1.11

SHEET #: 11 OF 12

ISSUE: ISSUED FOR TENDER

DATE OF: 0

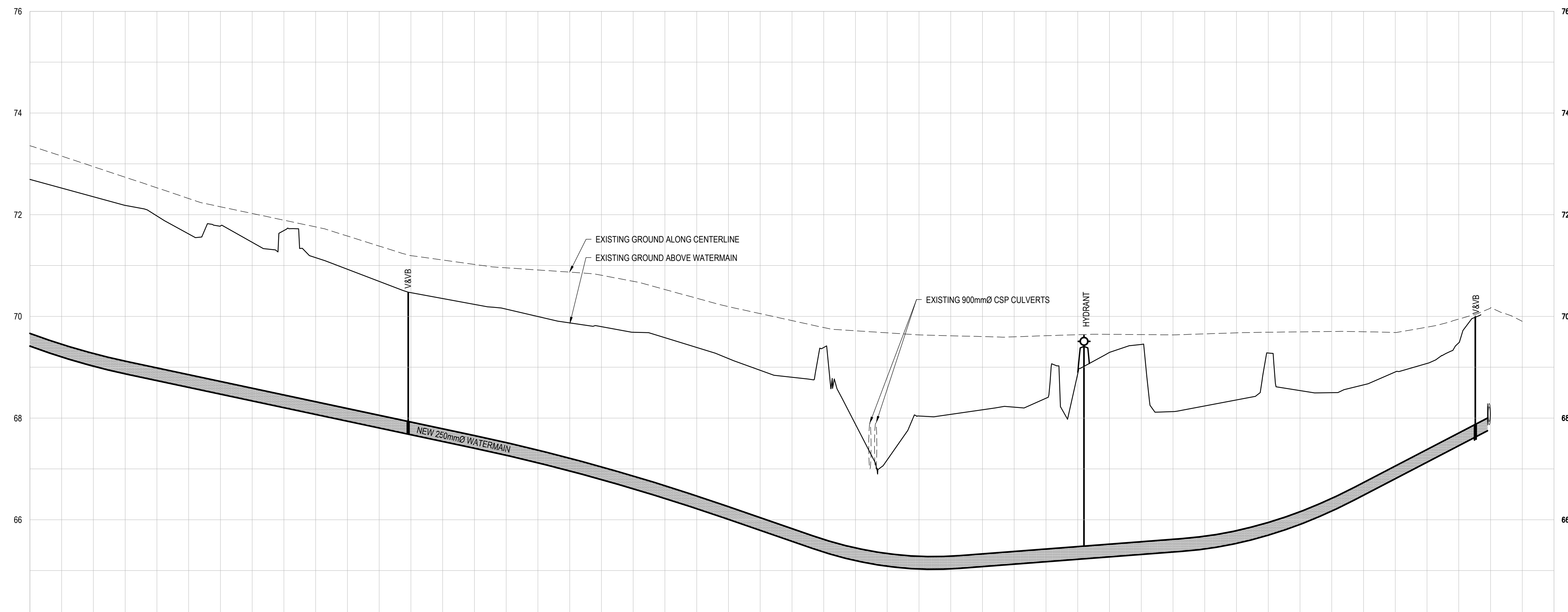

STATION	ROAD CENTERLINE AND EG OVER WM	EG OVER WM CENTERLINE	TOP OF WATERMAIN
10+175	73.36	73.36	69.66
10+200	72.35	72.35	69.27
10+225	71.98	72.53	68.99
10+250	71.78	72.16	68.72
10+275	71.69	71.89	68.45
10+300	70.93	71.56	68.19
10+325	70.47	71.19	67.92
10+350	70.24	71.02	67.66
10+375	70.00	70.81	67.37
10+400	69.80	70.61	67.04
10+425	69.58	70.53	66.67
10+450	69.17	70.19	66.26
10+475	68.80	69.92	65.83
10+500	67.88	69.72	65.45
10+525	68.04	69.64	65.28
10+550	68.16	69.60	65.33
10+575	68.39	69.62	65.42
10+600	68.29	69.65	65.52
10+625	68.13	69.64	65.62
10+650	68.36	69.68	65.79
10+675	68.54	69.70	65.16
10+700	68.65	69.70	65.73
10+725	68.07	69.79	67.38
10+750	70.17	70.17	

PLAN AND PROFILE LANDRY ROAD STA. 10+175 TO STA. 10+775

SHEET NUMBER: C1.11

SHEET #: 11 OF 12

ISSUE: ISSUED FOR TENDER

DATE OF: 0